

BIRDS

Materials

- Package of Smart-Fab Cut Sheets
- Piece of cardboard large enough for the body of the bird and wing support pattern
- Marker
- Knife
- Scissors
- Spray Adhesive
- Fabric glue or 3MScotchglue
- Pattern for body of bird and wing support ([click here for pattern](#))
- Patterns 1, 2, 3, 4 for crest, wings, tail ([click here for pattern](#))
- Invisible wire
- Wooden ring for hanging
- Loop made from Smart-Fab Cut Sheets or a small metal loop purchased at a craft store to use to attach bird(s) to the wooden ring for hanging.



Preparation



1. Print patterns
2. Choose color schemes.
We used the following from the Smart-Fab Cut Sheets:
Body-dark pink - 2 pieces,
wing support-dark pink - 2 pieces



2. Take the cardboard bird body and the wing support and trace onto the two Smart-Fab Cut Sheets you chose so that you have two of each shape.

PatternNo.1 crest - darkpink - 2 pieces, yellow - 2 pieces , orange - 1piece

PatternNo.2 wing - skyblue - 2 pieces, orange - 2 pieces , yellow - 2 pieces

PatternNo.3 wing - orange - 2 pieces, dark pink - 2 pieces , dark purple - 2 pieces, yellow - 2 pieces

PatternNo.4 wing and tail - apple green - 3 pieces, yellow - 3 pieces, dark purple - 1 piece, dark pink - 3 pieces, orange - 1 piece, cranberry - 2 pieces



a loop of Smart-Fab or a small metal loop purchased in a craft store.

3. Cut and glue the Smart-Fab to each side of the cardboard bird and wing support.

*However, do not glue the top of the bird's head securely until you have inserted the crest (pattern# 1) later on. *Also if you want to hang the bird, leave the two sides open on the top of the bird's body to fit

Procedure

Bird's Body

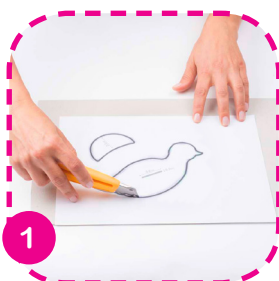

1. Glue patterns of the body of the bird and wing support on cardboard and cut out using a knife. Be sure to follow the pattern and cut out the straight line in the center of the body. This will be for the wing support.



4. Fit wing support into opening in the center of the bird.



Tail and Wings

1. Group colors together you chose for patterns #2 (wings-small), #3 (wings-large), #4 (tail), and cut shapes. Be sure on pattern #4 to follow all the lines. We also supported our bird to stand up during this process.



2. TAIL (Pattern #4)

Take about eight or nine pieces of the Smart-Fab you cut for the tail, leaving four pieces (two of one color and two of another color) to use on the wings, and glue together so the tail is elongated as shown in the picture.



3. WINGS (Patterns #2 ,#3 ,#4)

You will be gluing above and below the wing support on each side of the bird. Glue only a small part of the pieces of the wings to the wing support. Test how each layer looks before you glue it down. Adjust to make the wings look as full as possible. Check pictures to see details. You can change layering described below to achieve more fullness of your own design.

a. The first layer on the wing support will be the left over pieces from the tail (pattern #4). Glue the two pieces of Smart-Fab of two different colors only on the top of the wing support on each side of the bird.



b. Next, take two pieces of Smart-Fab of two different colors of the larger wing (pattern#3), fold them in half length wise and partially glue each wing together. Then glue them on top of each other on top of tail pattern on the wing support, on each side of the bird. Take two more of pieces of Smart-Fab of this wing pattern, and glue to underside

of each wing support on each side of the bird in the same way as we described.



c. To complete wings, take about three pieces of Smart-Fab of three different colors of the smaller wing (pattern #2). Fold and glue them as we described above, and either partially glue them on top of (pattern #3), or glue them together next to (pattern #3) on the top and bottom of the wing support on each side of the bird



Finishing Touches

1. CREST (Pattern #1)

a. Place pattern on the four small pieces of the two different colors of Smart-Fab Cut Sheets you chose for the crest. Trace and cut out the shapes. You can also make small cuts into the top of the crest to look more like feathers.

b. Glue two pieces of two different colors onto the cardboard on each side of the head of the bird where you left an opening. Then glue the space closed.



2. EYES

Make two small circles of a dark color (we used dark blue) from the Smart-Fab Cut Sheets, and two smaller circles of white. Glue the white circles onto the dark circles and use a black marker to make the pupils of the eyes. Glue to each side of the birds head.



3. BEAK

Cut a small square of yellow or orange Smart-Fab and cut off a corner. Fold the corner onto the beak, cut it to size and glue.



4. HANGING THE BIRDS (our way)

a. You need to take a small strip of Smart-Fab and fold it length wise to make loop to glue onto the top part of the bird for the invisible wire. Fold and glue the loop onto the bird's body where you left an opening. Then glue the opening closed on top of the loop. Look closely at the loops in our pictures.

(Or you can attach the metal loop from the craft store).



b. Take the amount of invisible wire you chose to hang your bird(s) and attach one end to the wooden ring. Take the other end and pass it through the loop on the bird(s) and knot onto the loop.

Then.....

WATCH YOUR SMART-FAB BIRDS FLY!!!

